

A G E N D A

OKLAHOMA COUNTY BOARD OF ADJUSTMENT MEETING ROOM 204 1:30 p.m.

April 7, 2026

FILED IN OFFICE
Oklahoma County Clerk

APR 01 2026

Deputy

1. Notice of meeting posted April 1, 2026.
2. Call to Order.
3. Roll Call.
4. Approval of the minutes of the previous meeting: (January 27, 2026).
5. Discussion and possible action for Approval/Denial of a Variance (VA-2026-01) to the Oklahoma County Zoning Regulations.

2026 APR 1 AM 8:57

Application of: **WATERLOO ROAD CHURCH OF CHRIST (ROGER EDMISON)**

The applicant is requesting a variance to the Oklahoma County sign regulations regarding pole sign locations and illumination. If approved, the applicant would be permitted to erect a pole sign with a transitional LED messaging screen for a church. The property in question is approximately 4.00 acres in size. The following is the site description to be considered:

A Tract of Land Situated in the NW/4 of Section Four (4), Township Fourteen (14) North, Range Two (2) West of the Indian Meridian, Oklahoma County, Oklahoma, more particularly described as follows: Beginning at a point on the North Section Line of said Section 4 a distance of 356.00 feet East (N89°52'32"E) of the Northwest Corner of said Section 4, Thence Continuing East (N89°52'32"E) a distance of 444.06 feet, Thence South (S00°00'0252'32"W) a distance of 392.38 feet, Thence West (S89°52'32"W) a distance of 444.06 feet; Thence North (N00°00'02"W) a distance of 392.38 feet to the Point of Beginning. Said tract containing 4.00 acres, more or less.

Less and Except a Strip, Piece or Parcel of Land Lying in Part of Government Lot 4 (NW/4 of Section 4, T14N, R2W) in Oklahoma County, Oklahoma. Said Parcel of Land Being Described as Follows: Commencing at the NW Corner of said Lot 4, Thence N89°34'25"E along said North Line a distance of 440.06 feet, Thence S00°00'00"W a distance of 85.02 feet, Thence N89°43'58"W a distance of 439.74 feet, Thence N00°19'59" W a distance of 72.02 feet to the Point of Beginning. Containing 0.46 acres, more or less.

Location: 4404 E Waterloo Rd Edmond, OK 73034 (County Highway District #3)

6. Discussion and possible action for Approval/Denial of a Variance (VA-2026-02) to the Oklahoma County Zoning Regulations.

Application of: **GOLD LEAF PROPERTIES**

The applicant is requesting a variance to 150-foot section line road setback requirements in PUD-2023-09. Said PUD is governed by the CG – Commercial General zoning district. If approved,

the applicant would be permitted to construct a dental clinic up to 10 feet into the front-yard setback along Waterloo Rd and up to 50 feet into the front-yard setback along Sooner Rd. The property in question is approximately 1.60 acres in size. The following is the site description to be considered:

Lot One A (1A) in Jackalope Corner an Addition to Oklahoma County, Oklahoma, according to the Recorded Plat Thereof

Location: 6800 N Sooner Rd Edmond, OK 73034 (County Highway District #3)

7. **New Business:** In accordance with the open Meetings Act, Section 311.9, New Business is defined, as any matter not known about, or which could not have been reasonably foreseen prior to the time of posting the agenda.
8. **Adjournment of Meeting.**

OKLAHOMA COUNTY BOARD OF ADJUSTMENT
 VARIANCE (VA-2026-01)
 TRANSITIONAL LED POLE SIGN INSTALLATION
 LOCATION: 4404 E WATERLOO RD
 PROPOSED USE: SIGN FOR CHURCH

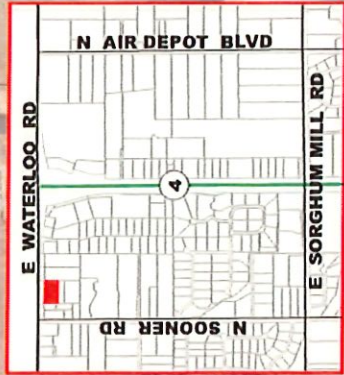

SECTION 4, T-14-N, R-2-W, L.M.
 LOCATION MAP



**OKLAHOMA COUNTY
 ENGINEERING & PLANNING**

320 Robert S. Kerr, Suite 201
 Oklahoma City, OK 73102-3431
 County Engineer : Stacey Trumbo, P.E.

Date:
MARCH 2026

Scale:
 1" = 1,200'
 1" = 100'

Drawn By:
SCM

**6 OKLAHOMA COUNTY BOARD OF ADJUSTMENT
VARIANCE (VA-2025-02) - FRONT-YARD SETBACK
ENCROACHMENT
LOCATION: 6800 N SOONER RD
PURPOSED USE: DENTAL CLINIC**

E WATERLOO RD



**140' SETBACK
WATERLOO**

150' SETBACK

N SOONER RD

**100' SETBACK
SOONER**

150' SETBACK

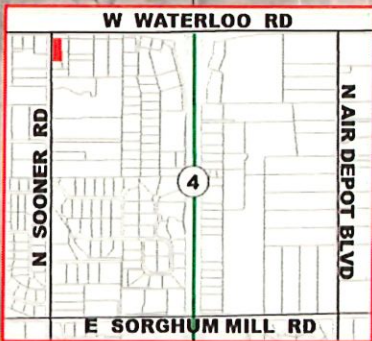
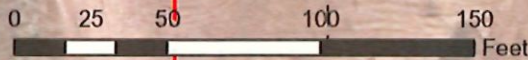

**SECTION 4, T-14-N, R-2-W, I.M.
LOCATION MAP**



**OKLAHOMA COUNTY
ENGINEERING & PLANNING**

320 Robert S. Kerr, Suite 201
Oklahoma City, OK 73102-3431
County Engineer : Stacey Trumbo, P.E.

Date:
MARCH 2026

Scale: **1:720**
1" = 60'

Drawn By:
SCM