

SURVEY CONTROL DATA

1. BEARINGS:
 THE BEARINGS SHOWN HEREIN OR HEREON ARE GRID BEARINGS DERIVED FROM THE USC & GS OKLAHOMA PLANE COORDINATE SYSTEM AND ARE NOT ASTRONOMICAL.
2. VERTICAL CONTROLS:
 A. LEVEL DATUM IS MEAN SEA LEVEL (USC & GS).
 B. ACCURACY - 3RD ORDER OR BETTER.

BRIDGE "A"
 LATITUDE 35° 34' 47" N
 LONGITUDE 97° 08' 56" W

BRIDGE "B"
 LATITUDE 35° 36' 31" N
 LONGITUDE 97° 10' 16" W

DESIGN DATA (BRIDGE "A")

ADT 2017 - 290
 ADT 2037 - 430
 DD% - 55
 T3 (%ADT) - 12
 V - 45 M.P.H.
 Flex ESALs - 0.33 M

DESIGN DATA (BRIDGE "B")

ADT 2017 - 1,710
 ADT 2037 - 2,540
 DD% - 55
 T3 (%ADT) - 12
 V - 45 M.P.H.
 Flex ESALs - 1.95 M

SCALES

PLAN 1:10
 PROFILE HOR. 1:10
 VER. 1:10
 LAYOUT MAP 1" = 7300'

CONVENTIONAL SIGNS

- PROPOSED ROADS
- SECTION LINES
- QUARTER SECTION LINES
- FENCES
- EXISTING GRADE
- EXISTING ROADS
- BASE LINE
- PROPOSED GRADE
- COMMUNICATION LINES (EXISTING)
- POWER LINES (EXISTING)
- GAS LINE (EXISTING)
- SANITARY SEWER LINES (EXISTING)
- WATER LINES (EXISTING)
- COMMUNICATION LINES (PROPOSED)
- POWER LINES (PROPOSED)
- GAS LINE (PROPOSED)
- SANITARY SEWER LINES (PROPOSED)
- WATER LINES (PROPOSED)
- BUILDINGS
- DRAINAGE STRUCTURES (EXISTING)
- DRAINAGE STRUCTURES (PROPOSED)
- RIGHT-OF-WAY LINES (EXISTING)
- RIGHT-OF-WAY LINES (PROPOSED)
- RIGHT-OF-WAY FENCE
- FLOWLINE (EXISTING)
- FLOWLINE (PROPOSED)
- TOE OF SLOPE (EXISTING)
- TOE OF SLOPE (PROPOSED)
- CITY LIMITS
- LANDSCAPE

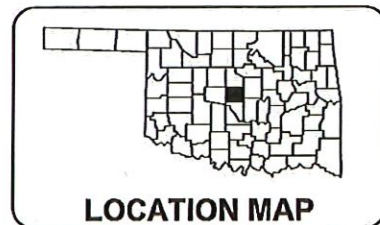

STATE OF OKLAHOMA
 PLAN OF PROPOSED
COUNTY BRIDGE
 BRIDGE AND APPROACH PLANS
DISTRICT 2 BOXES
OKLAHOMA COUNTY

LOCATION "A": 55E0990N3280006
 LOCATION "B": 55E0970N3270003

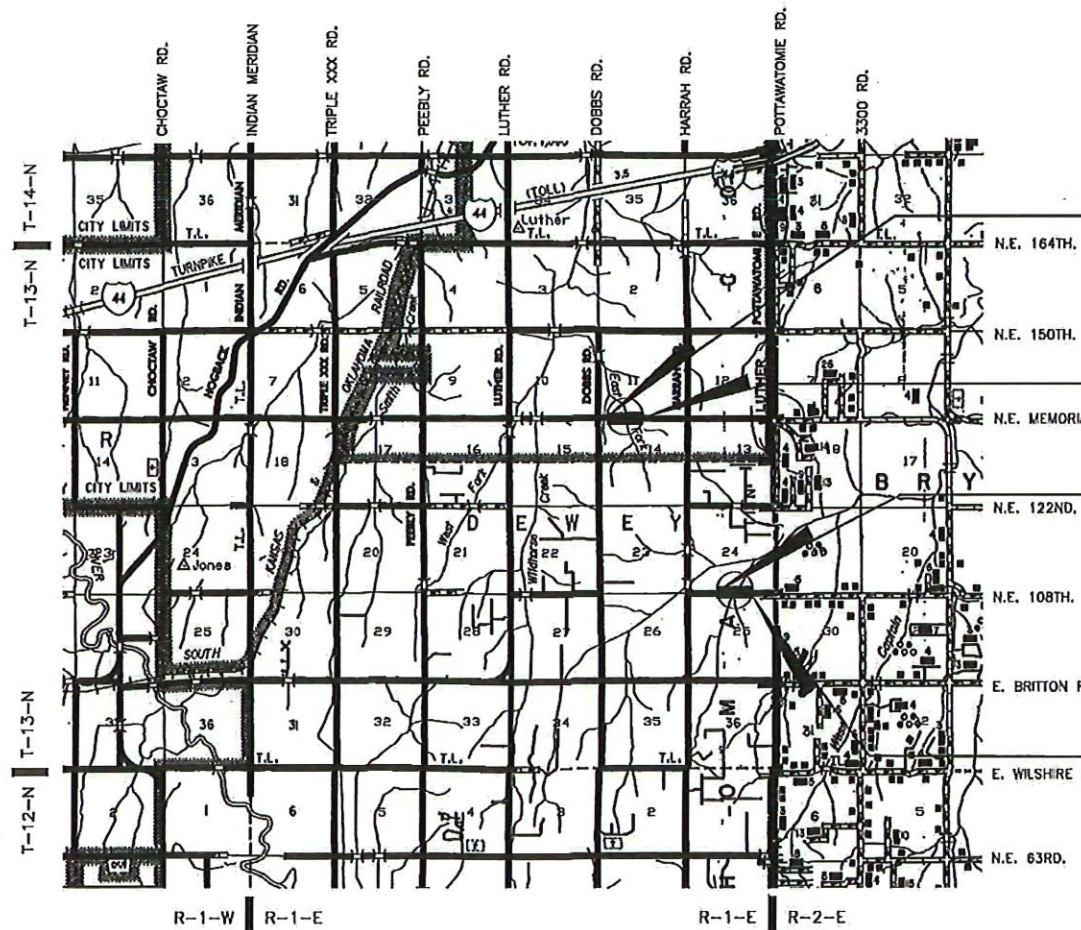

STA. 115+00.00
BEGIN MEMORIAL RD.

BEGIN BRIDGE "B" 116+67.92
BRIDGE LENGTH 22.67'
END BRIDGE "B" 116+90.59

STA. 119+00.00
END MEMORIAL RD.

STA. 228+00.00
BEGIN 108TH ST.

BEGIN BRIDGE "A" 229+32.29
BRIDGE LENGTH 26.56'
END BRIDGE "A" 229+58.85

STA. 231+50.00
END 108TH ST.

INDEX OF SHEETS

SHEET NO.	DESCRIPTION
0001.	TITLE SHEET
0002.	TYPICAL SECTION AND MISCELLANEOUS DETAILS
AU01.	SUMMARY OF PAY QUANTITIES AND GENERAL NOTES
B001.	GENERAL PLAN & ELEVATION BRIDGE "A"
B002.	BRIDGE "A" DETAILS
B003.	GENERAL PLAN & ELEVATION BRIDGE "B"
B004.	BRIDGE "B" DETAILS
R001.	STORM WATER MANAGEMENT PLAN BRIDGE "A"
R002.	STORM WATER MANAGEMENT PLAN BRIDGE "B"
R003.	DRAINAGE MAPS AND DESIGN RECORD
R004.	ALIGNMENT DATA AND RIGHT-OF-WAY
R005.	ROAD CLOSURE DETAIL
R006.	BRIDGE "A" CHANNEL EMBANKMENT GRADING PLAN
X001.-X004.	X - SECTIONS BRIDGE "A"
X005.-X009.	X - SECTIONS BRIDGE "B"

THE FOLLOWING STANDARDS WILL BE REQUIRED FOR THIS PROJECT.

ROADWAY	TRAFFIC
SSS-1-1	PM3-1-02
TSC2-3-2	TCS1-1-01
TSD-2-0	TCS2-1-00
PSE-1-0	TCS4-1-01
SBI-4-2	TCS5-1-00
RWF2-2-1	TCS7-1-02
	TCS9-1-01
	TCS14-1-00

APPROVED
 OKLAHOMA COUNTY BOARD OF COMMISSIONERS

DISTRICT NO. 1 _____ DATE: _____

DISTRICT NO. 2 _____ DATE: _____

DISTRICT NO. 3 _____ DATE: _____

ATTEST _____

COUNTY CLERK _____ DATE: _____

AARON FINLEY
 24264
 OKLAHOMA

PREPARED BY:
 CEC CORPORATION
 CA32 6/30/2018
 OKLAHOMA CITY, OKLAHOMA

Aaron Finley
AARON FINLEY
 OKLA. REG. NO. 24264

CEC
 4/6/18
 DATE

OKLAHOMA COUNTY

DATE APPROVED _____

BY _____

COUNTY ENGINEER

PROJECT LENGTH BASED ON C.R.L.

ROADWAY LENGTH: 750.00 FT. 0.142 MILES
 BRIDGE "A" PROJECT LENGTH: 26.56 FT. 0.005 MILES (BRIDGE IN PLACE)
 BRIDGE "B" PROJECT LENGTH: 22.67 FT. 0.004 MILES (BRIDGE IN PLACE)
 TOTAL PROJECT LENGTH: 0.142 MILES

EQUATIONS: NONE
 EXCEPTIONS: NONE

2009 OKLAHOMA STANDARD SPECIFICATIONS FOR HIGHWAY CONSTRUCTION-ENGLISH GOVERN,
 APPROVED BY THE U.S. DEPARTMENT OF TRANSPORTATION, FEDERAL HIGHWAY
 ADMINISTRATION, JANUARY 4, 2010.